



HIZLI VE KOLAY MONTAJ
FAST AND EASY ASSEMBLY



UV IŞINLARINA DAYANIKLI
RESISTANT TO UV RAYS



ÇEVRE DOSTU
ENVIRONMENTALLY FRIENDLY



SİGARA ATEŞİNE KARŞI DAYANIKLI
RESISTANT TO CIGARETTE FIRE



MOBİLYA AYAKLARI AŞINDIRMAZ
RESISTANT TO FURNITURE WHEEL ABRASION



E1 KALİTE
E1 GRADE



TAŞIYICI LEVHA, YÜKSEK YOĞUNLUKTA LİF LEVHA
BASE PANEL, HIGH DENSITY FIBERBOARD



KOLAY TEMİZLENİR, HİJYENİKTİR
EASILY CLEANED AND MAINTAINED, HYGIENIC



ÇİZİLMEMEYE DAYANIKLI
RESISTANT TO SCRATCH



NOKTASAL DARBELERE DAYANIKLI
RESISTANT TO POINT STRIKES



ZEMİNDEN İSTİHMAYA UYGUN
SUITABLE FOR UNDERFLOOR HEATING



LEKELERDEN ETKİLENMEZ
NOT AFFECTED BY STAINS

FLOORPAN NATURAL Laminat Parkenin Üstünlükleri

The Advantages of FLOORPAN NATURAL Laminated Flooring

- + Hijyeniktir.
- + Üstün formunu uzun yıllar korur.
- + Kilitli olması nedeniyle kolay söküp takılabilir.
- + Kolay temizlenebilir.
- + Çizilmeye dayanıklıdır.
- + Desen ve yüzey alternatifleri çoktur.
- + UV ışınlarına dayanıklıdır.
- + Ev kimyasallarına dayanıklıdır.
- + E1 normlarına uygundur. Sağlıktır.
- + Isı tasarrufu sağlar.
- + Leke tutmaz.
- + Hygienic.
- + Maintains its superior form for years.
- + Can be installed and disassembled easily due to click lock.
- + Easily cleaned.
- + Resistant to scratch.
- + Many decor and surface alternatives.
- + Resistant to UV rays.
- + Resistant to household chemicals.
- + Suitable to E1 norms and resistant to the growth of mold and bacteria.
- + Energy saving.
- + Stain-resistant.

FLOORPAN NATURAL

www.keas.com.tr | www.floorpan.com.tr

KastamonuEntegre.A.S | Floorpan-Parke KeasKurumsal KastamonuEntegre A.S. | kastamonuentegre

AĞUSTOS / AUGUST 2017

FLOORPAN NATURAL

ÜRÜN BROŞÜRÜ | PRODUCT BROCHURE 2017



KALICI DOĞALLIK CONSISTENTLY NATURAL

mikro
derzli

32 AC4 15 YIL GARANTİ 15 YEARS GUARANTEE 10 mm

FNO12 Natural Çam

kastamonu

LAMİNAT PARKE LAMINATE FLOORING

FLOORPAN **NATURAL**, ZENGİN RENK VE DESEN ÇEŞİDİ İLE AHŞABIN DOĞALLIĞINI MEKANLARINIZA TAŞIR. FLOORPAN **NATURAL** LAMİNAT PARKE, KOMPLE BİR YER DÖŞEMESİ SİSTEMİ OLARAK AVRUPA STANDARTLARINDA **AC4** SEÇENEKLERİYLİ DÖRT TARAFI DERZLİ (PAHLI) VE 10 mm KALINLIĞINDA ÜRETİLİR.

FLOORPAN **NATURAL**, WITH ITS RICH COLOR AND PATTERN VARIETY, ADDS THE NATURALNESS OF THE WOOD TO YOUR LIVING SPACES. FLOORPAN **NATURAL** LAMINATE FLOORING IS PRODUCED AS AN EUROPEAN CLASS COMPLETE FLOORING SYSTEM WITH **AC4** OPTIONS.



KORUYUCU TABAKA | OVERLAY

Üstün nitelikli, aşınmaya ve çizilmeye dayanıklı film tabakası
High quality surface protection resistant to wear and scratch

DEKOR KAĞIDI | DECOR PAPER

Ürünün karakteristik özelliklerini benzersiz tasarımı ile yansıtır
Reflecting the characteristics of the product with a unique design

YÜKSEK YOĞUNLUKTA LİV LEVHA | HDF

E1 Normuna göre üretilmiş, sağlam, yüksek basınca karşı dirençli taşıyıcı tabaka
Strong base panel, resistant to high pressure produced as per E1 norm

BALANS KAĞIDI | BALANCE PAPER

Nem ve çarpılma önleyici
Protects against humidity and distortion

FLOORPAN **NATURAL** LAMİNAT PARKE 15 YIL GARANTİSİ İLE SATIŞ SONRASI İÇİN DE AVANTAJ SAĞLAR.



FLOORPAN **NATURAL** LAMINATED FLOORING GIVES FURTHER ADVANTAGE AFTER SALES WITH 15 YEARS GUARANTEE.

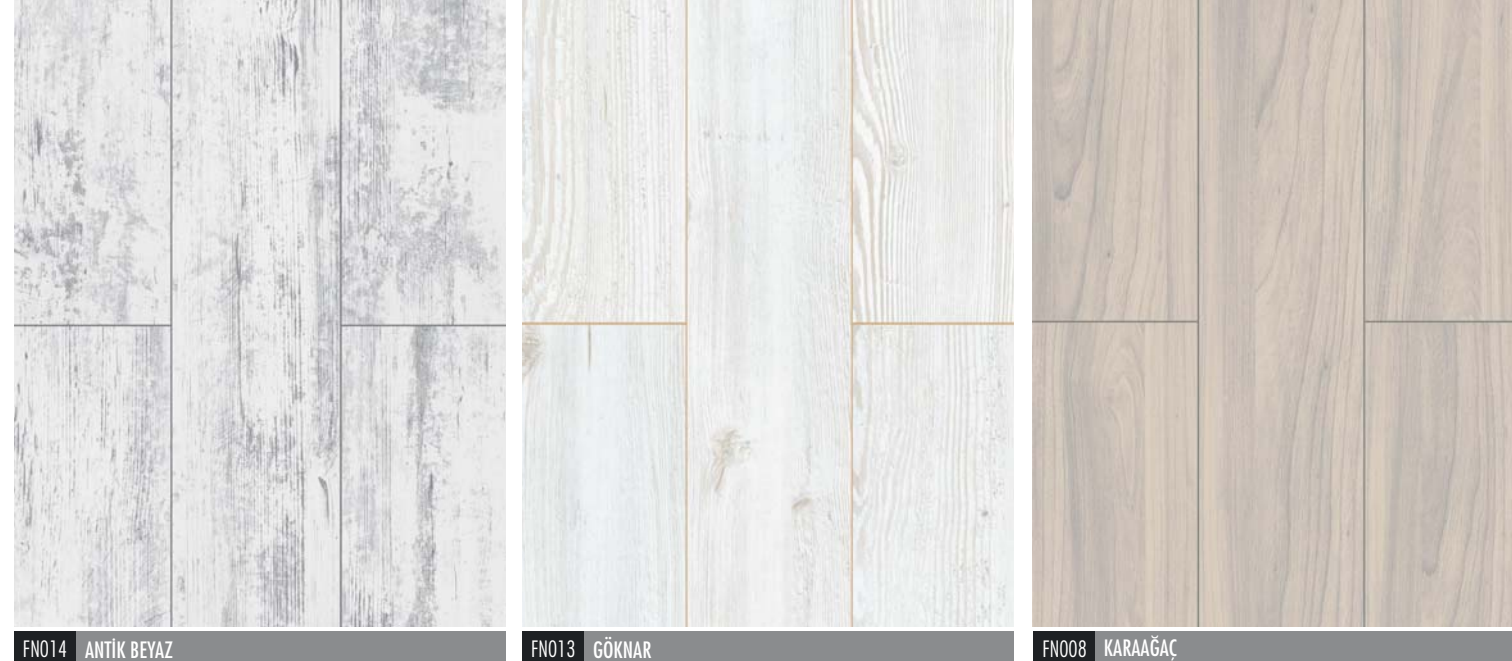

FN014 ANTİK BEYAZ

FN013 GÖKNAR

FN008 KARAAĞAÇ



FN012 NATURAL ÇAM

FN009 LEFKAS MEŞE



FN011 ATLANTİK MEŞE



FN003 JAKARTA MERBAU



FN002 Milano Meşe

Döşeme İşlemi - Flooring Application

A. Döşeme işleminin önce

Döşeme yapılacak zemin ve ortamın ısı ile nem koşulları; Döşeme yapılacak zemin ve ortamın ısı ve nem seviyeleri, döşeme işleminin önce, döşeme işlemi sırasında ve işlemin sonra döşeme için uygun ısı ve bağıl nem şartlarına uygun olmalıdır. (Döşeme yapılacak ortamın sıcaklığı min. +18 °C olmalıdır. Zemin sıcaklığı min. +15°C derece olmalıdır. Döşeme yapılacak ortamın bağıl nem oranı max. %75 olmalıdır)

Döşeme yapılacak zeminin yüzeyi

Yüzeyi FLOORPAN NATURAL Laminat Parke döşenecek olan tüm zeminleri, tüm diğer aralıklarda da aynı şekilde bir önceki sıranın arka kalan kaplama paneliyle kaplayın.

Zemin denetlenirken özellikle aşağıdaki şartların yerine gelmiş olmasına dikkat edilmelidir.

Zemin kuruluk seviyesi
Yüzeyin düzlük kontrolü (Yüzeydeki dalgalanma bir metrede max. 4 mm olmalıdır.) Döşeme yapılacak zeminin dayanımı/hesap kapasitesi

Zemin sertliğinin kontrolü

Yüzeyin düzlük kontrolü (Yüzeydeki dalgalanma bir metrede max. 4 mm olmalıdır.) Döşeme yapılacak zeminin dayanımı/hesap kapasitesi

Zemin nem seviyesinin kontrolü

Yüzeyin düzlük kontrolü (Yüzeydeki dalgalanma bir metrede max. 4 mm olmalıdır.) Döşeme yapılacak zeminin dayanımı/hesap kapasitesi

B. Önce

2. İlk sıranın son elemanı üzerinde gerekli uzunluğu işaretleyiniz (yayın birimine bakarak şekilde konuyunuz) ve fazla gelen kısmı kesiniz. İkinci sıranın kaplama elemanından arka kalan parça en az 200 mm uzunlukta ise ikinci sıranın döşemesine bu parça ile başlayınız. Tüm diğer aralıklarda da aynı şekilde bir önceki sıranın arka kalan kaplama paneliyle kaplayın.

3. İkinci sırayı

Dikkat! Kenar birleşmeleri en az 200 mm kaydırmalı olarak gerçekleştirilmelidir. Fabrika çıkış eğri bir kenar ve/veya özel desene (örn. dekor fayansı) sahip duvarlarda eğri kenara ve/veya desene göre eşit aralıklarla kaydırmaya dikkat ediniz.

4. Arka eleman eleman, sıra sıra

5. Son eleman sırasını işaretlemek için, döşenecek olan kaplama elemanından son bir önceki sıranın tam üstüne koyunuz. Arka bir paneli parçasıyla (eleman genişliği + kenar derzi genişliği) duvar kenarını önceden belirlenen bir mesafede kaplama elemanına oturtulmalıdır.

31, 32 ve 33 sınıfına dahil işyerlerinde döşeme işlemi

Bu yapıların sınıfına dahil işyerlerinde ortamların üstünde gerçekleştirilen bir nem faktörü göz önünde bulundurulmalıdır. Bu nedenle, bu uygulamalarınızda sistem malzemesinin arızası yer alan özel bir yalıtım türünün kullanılmasına karar verilmelidir. Su geçirimsiz bir yalıtım türü, duvar ve zemin kenarlarına kaplama elemanlarının altına yerleştirilmelidir. Bu işlemi gerçekleştirirken, duvar kenarlarındaki boşlukları, kaplama elemanlarının altına yerleştirilmelidir. Bu işlemi gerçekleştirirken, duvar kenarlarındaki boşlukları, kaplama elemanlarının altına yerleştirilmelidir.

Dikkat! Tozdan yalıtım türünün altına kaplama elemanlarının arasında

değer oluşturulmalıdır. Dikkat! Tozdan yalıtım türünün altına kaplama elemanlarının arasında değer oluşturulmalıdır.

Essential rules in flooring

PF sheet of 0.2 mm in thickness should be applied across the full area of the surface with an edge tolerance of 20 cm in superposed form for humidity isolation of the surface. Before the floor is installed, the coat should be laid to cover the whole surface in parallel to the long edge of floor panels to ensure sound, heat and humidity isolation for the surface and eliminate surface burrs (if less than 2 mm). While laying the blanket strips adjacently, the edges should be adjoined (no uncovered area left)

Two short edge joints should be less than min. 300 mm.

In the floored area, a clearance of 15 mm should be left between the FLOORPAN NATURAL Formatted Floor and all fixed sides (wall, central heating tube etc).

Floor panels should be laid in a max length of 10 m and max width of 8 m. Transition profiles should be used in areas exceeding these dimensions.

Defected and inappropriate panels should be eliminated before and during the application.

B. Flooring application

1. Check that no defect is present on any surface element. Please examine the curve and groove of surface pieces (see Figure 1). Start to lay the first row from the left side of the room with both curved sides of the piece facing the wall (see Figure 2). Fit distance holders allowing the desired clearance between the wall before starting the flooring work (see Figure 3). Hold inclined the piece to be laid and fit it into the joint mechanism of the laid piece.

A. Before flooring

Heat and humidity conditions of the environment the surface to be floored:
Heat and humidity levels of the environment and the surface to be floored should meet suitable heat and relative humidity conditions before, during and after the flooring. (Average temperature of the flooring environment should be min +18 °C and the surface temperature should be min +15 °C. Relative humidity of the flooring environment should be max 75%).

Surface to be floored

All surfaces to be floored with FLOORPAN NATURAL Laminated Floor should be suitable for technical conditions necessary for flooring.

The dryness level of the surface

Check the surface smoothness (Surface fluctuation should not exceed max 4 mm per metre). Strength/bearing capacity of the surface to be treated,

Checking the rigidity of the surface

Purity of the surface to be floored (dust, dirt, etc). In addition to the cement finish, any previous coat on the surface such as PVC, linoleum, rubber or wooden surface coats receive flooring, yet the above-mentioned conditions should again be satisfied for this treatment.

The FLOORPAN NATURAL Laminated Floor may be applied

to surfaces where water-circulated and floor-heated systems are employed. In such a case, please ask for special flooring instructions from your supplier (flat or corrugated kraft paper). Furthermore, for electrical floor-heating system is fitted into the cement finish or layer (if the heating system is not above the concrete layer), flooring can be applied. The surface temperature of the ground should not exceed 28 °C. In case warranty applying that surface temperature would not exceed 28 °C can be assured from the manufacturer, adjustable plate heating system can be allowed for use as the floor surface. Common available electrical floor-heating systems with water materials has been prescribed between in such fields of application. While joining all coating pieces on the full row ensuring the link along the narrow and long side, apply the leakproof adhesive on the upper part of the groove in a way that the adhesive overflows upward. The overflowing insulation adhesive can conveniently be removed away from the surface immediately or after a short drying period.

Surfaces not suitable for FLOORPAN NATURAL Laminated Parquet application

Surfaces with textile materials (carpet, rug,... etc) on Wet spaces such as toilet, bath, sauna

Essential rules in flooring

PF sheet of 0.2 mm in thickness should be applied across the full area of the surface with an edge tolerance of 20 cm in superposed form for humidity isolation of the surface. Before the floor is installed, the coat should be laid to cover the whole surface in parallel to the long edge of floor panels to ensure sound, heat and humidity isolation for the surface and eliminate surface burrs (if less than 2 mm). While laying the blanket strips adjacently, the edges should be adjoined (no uncovered area left)

As FLOORPAN NATURAL Laminated Floors are laid on the surface

in last system, no screwing, nailing or bonding treatment is necessary.

Two short edge joints should be less than min. 300 mm. In the floored area, a clearance of 15 mm should be left between the FLOORPAN NATURAL Formatted Floor and all fixed sides (wall, central heating tube etc).

Floor panels should be laid in a max length of 10 m and max width of 8 m. Transition profiles should be used in areas exceeding these dimensions.

Defected and inappropriate panels should be eliminated before and during the application.

B. Flooring application

1. Check that no defect is present on any surface element. Please examine the curve and groove of surface pieces (see Figure 1). Start to lay the first row from the left side of the room with both curved sides of the piece facing the wall (see Figure 2). Fit distance holders allowing the desired clearance between the wall before starting the flooring work (see Figure 3). Hold inclined the piece to be laid and fit it into the joint mechanism of the laid piece.

Then lay it so that it seats evenly on the surface and join all the pieces

(See Figure 3-1 to 3-3).

2. Mark the required length on the last piece of the first row (question so that the curves face each other) and cut the projecting part. If the residual part of the flooring piece for the first row is min 200 mm in length, then start laying the second row with this piece. The same starting procedure is applied to all other rows, namely flooring is started with the residual part of the previous row.

Attention! Edge joints should be implemented in a minimum shift

of 200 mm. For products with a factory-curved side and/or special pattern (for example decorative tile), be careful to apply a uniform shift based on the curved side and/or pattern.

3. After the first row is laid, start the second row with the residual

part of the first row or the piece adapted to the curved side and/or pattern. Fit the curve of this piece to the lower projecting lip of the first piece (see Figure 4) and join all other panels from the narrow sides as explained above until the entire row is finished (see Figure 5 and 6). So, all narrow sides of these row panels are aligned and joined. Now, lift slightly the first panel or the panel section and join with the first row from the longitudinal side. Until the full row units with the previous row, repeat this procedure (see Figure 7 and 8). Meanwhile, ensure that no shift occurs in panels along the narrow edges.

4. Now you can start piece to piece to piece or row-to-row flooring.

5. To mark the last piece row, place the last piece to be laid exactly on the previous penultimate row. Wall contour may be included to the coating component of a predefined distance with a residual panel piece (piece width+edge joint width)

Flooring in workspaces falling in category 31, 32 and 33 An

overall average humidity factor should be considered in workspaces falling in this category. Therefore, use of a special insulation adhesive between system materials has been prescribed between in such fields of application. While joining all coating pieces on the full row ensuring the link along the narrow and long side, apply the leakproof adhesive on the upper part of the groove in a way that the adhesive overflows upward. The overflowing insulation adhesive can conveniently be removed away from the surface immediately or after a short drying period.

Attention! Ensure that no joint occurs between the coating pieces

beneath the overflowing insulation adhesive.

Door jambs

If wooden door jamb is present, it is recommended to trim the length of the door by the floor's elevation from the surface. The thickness of the flooring material. Install the laminated parquet until the door bottom with a clearance. Lift on the wall edge. If you terminate the flooring on such a jamb, the interlock mechanism on the projecting lower lip of the last piece laid should be cut and removed by means of a chisel to join the new coating panel in laying position. This connection joint should be fixed with PVAC adhesive. Wall /door joints fitted in doorways such as metal door jambs not available for trim should be coated or covered with an elastic joint material or appropriate cover profiles.

Measure the pipe sizes and mark them on the coating pieces

(consider the side joint). Bore the holes so that their diameter exceeds the pipe diameter by min 1.6 mm.

Cut the coating piece by drawing near the holes at an angle of 45°. Adapt the cut and removed piece to its seat and glue it.

C. After flooring

Plastic or felt pieces should be placed below the feet of fixed or mobile furniture.

When replacing any heavy furniture, lift to carry them instead of dragging.

Wheels of wheelchairs, seats and sofas should be soft. Clean the floor surface without wetting it by means of a well-wringed hair-free micro-fiber cloth.

Do not use any abrasive cleaning material. Do not sand the floor.

KULLANIM - UTILIZATION	KONUT - DOMESTIC			TİCARİ - COMMERCIAL			ÖLÇÜLER - DIMENSIONS					
	AZ LOW	ORTA MEDIUM	YOĞUN INTENSIVE	AZ LOW	ORTA MEDIUM	YOĞUN INTENSIVE	KALINLIK - THICKNESS	BOY - LENGTH	EN - WIDTH	PAKET ADET - PIECES PER PACKAGE	PAKET - PACKAGE m ²	PAKET - PACKAGE kg
SINIF - CLASS												
AŞINDIRMAYA DAYANIKLILIK ABRASION RESISTANCE	21	22	23	31	32	33						
ÜÇ TEST SONUCUNDAN ORT. İP DEĞERİ AVERAGE İP VALUE FROM 3 TEST RESULTS.	≥900	≥1500	≥2000	≥4000	≥6000							
	P	10 mm	1295 mm	155 mm	6 Adet - Pieces	1,205 m ²	11,2 kg					

P. PLUS / ADANA

Kolay kilitlenen, hızlı uygulanır - Easily clicked and quickly installed

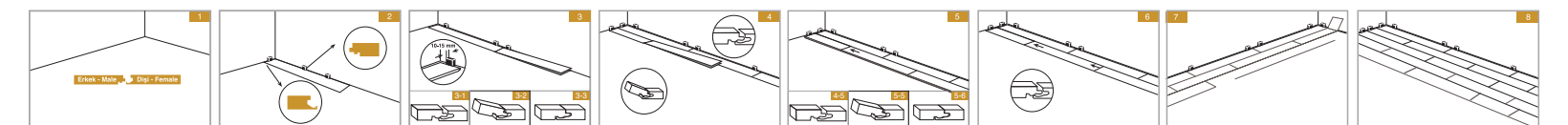

Renkler dijital ortamda farklılık gösterebilir. Lütfen orijinal numune ile kontrol ediniz. / Colors might vary on digital media. Please compare with an original sample.